

KITCHEN ISLAND

www.bloomstoneslondon.com

Bloom Stones London, Unit G, Acorn Industrial Park, Crayford Road, Dartford
DA1 4FL, United Kingdom

Phone: 020 3774 9683

Titanium Gold Granite / Exotic Average Size: 3.20m x 2.00m



Cosmic Black



Granite / Exotic

Average Size: 3.10m x 1.90m

Granite Slabs: Generally measure 108–132 inches (9–11 ft) long by 60–78 inches (5–6.5 ft) wide.
108 inches = 2743 – 3352
1524 – 1981

Our kitchen island is 1302 x 1720 The average slab is length 3100-3200 and width 1900-2000
The kitchen island on plan is 2300 length and 927 width - best to extend to max ie 3100 length and width 1200 leaving strip for kitchen 3100 x 650

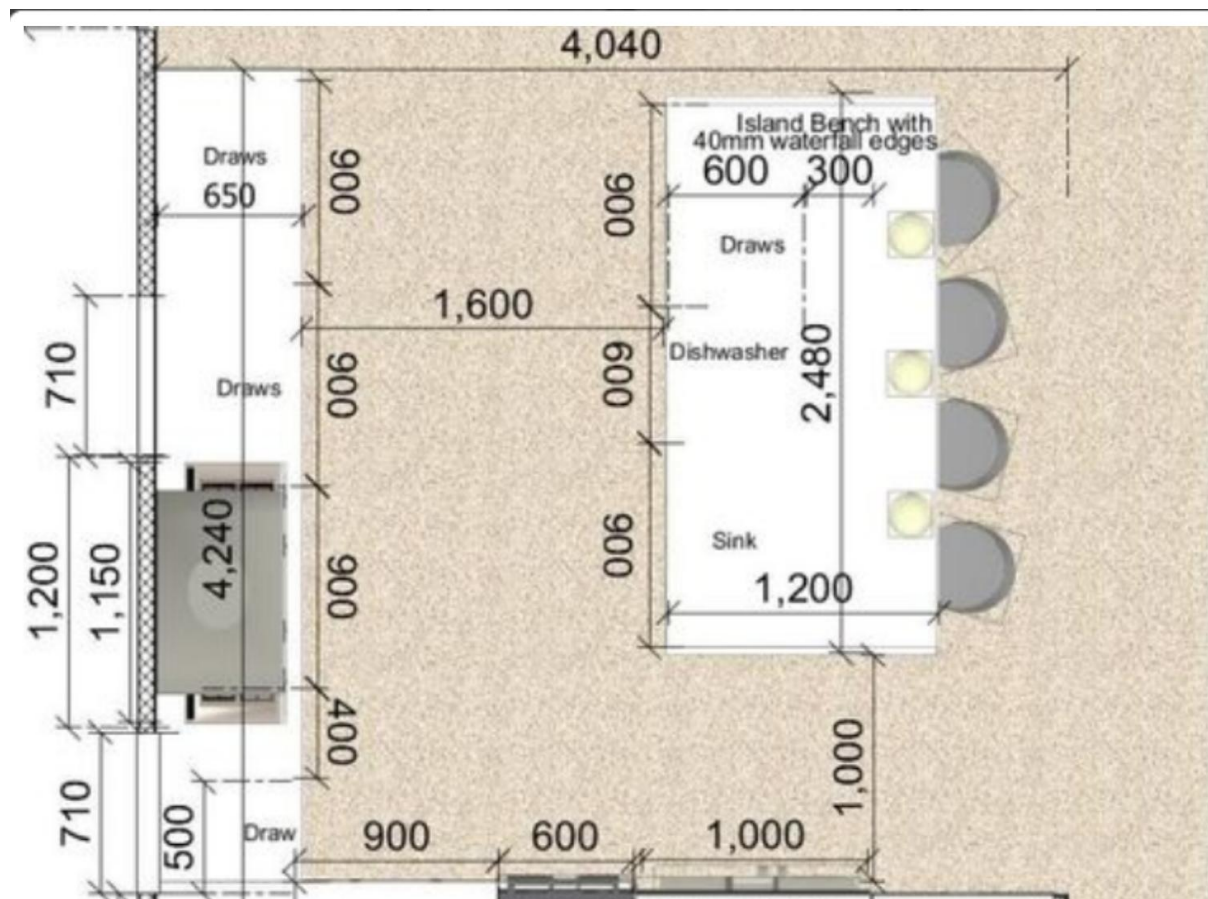

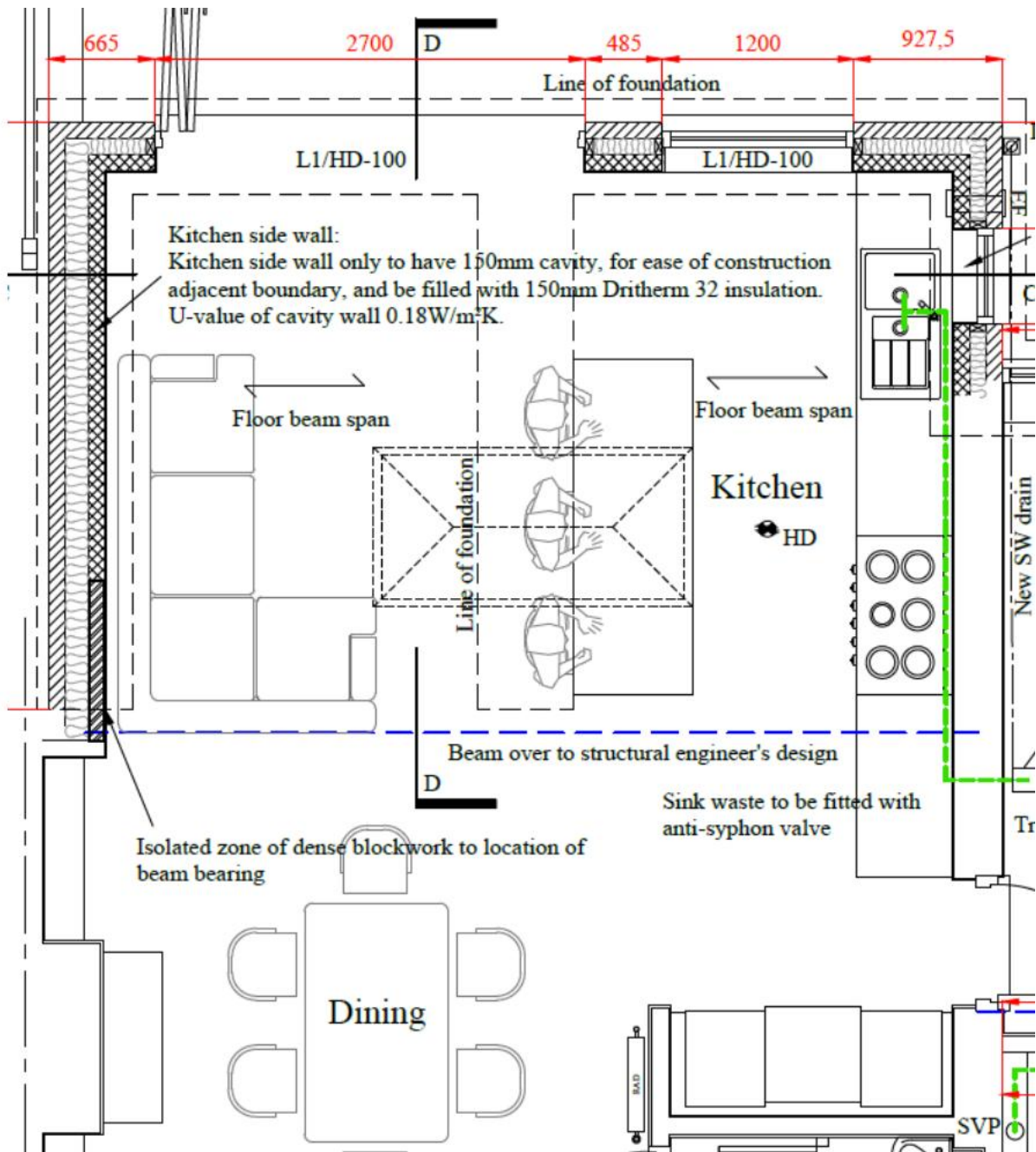



ljen crystal work tops quartzine

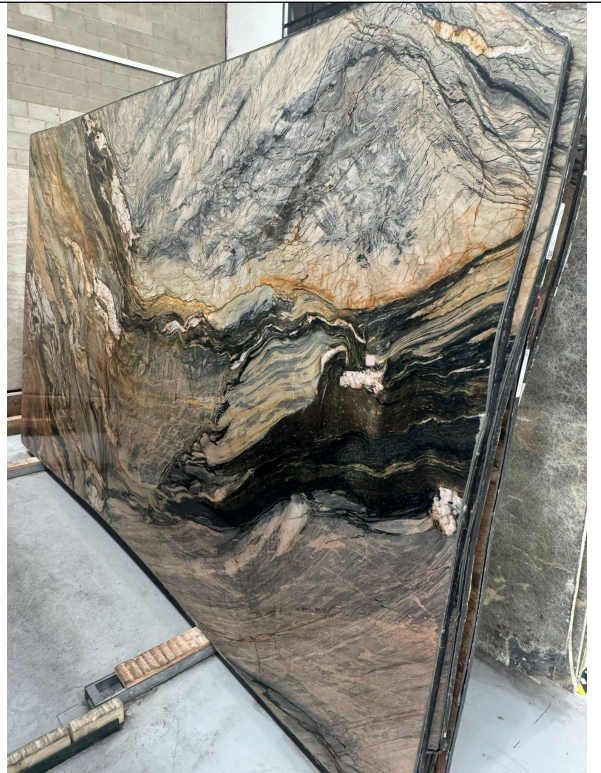



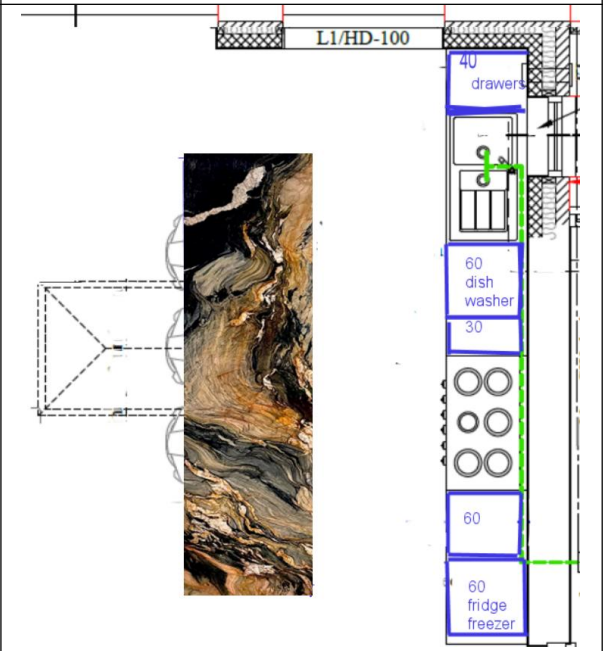
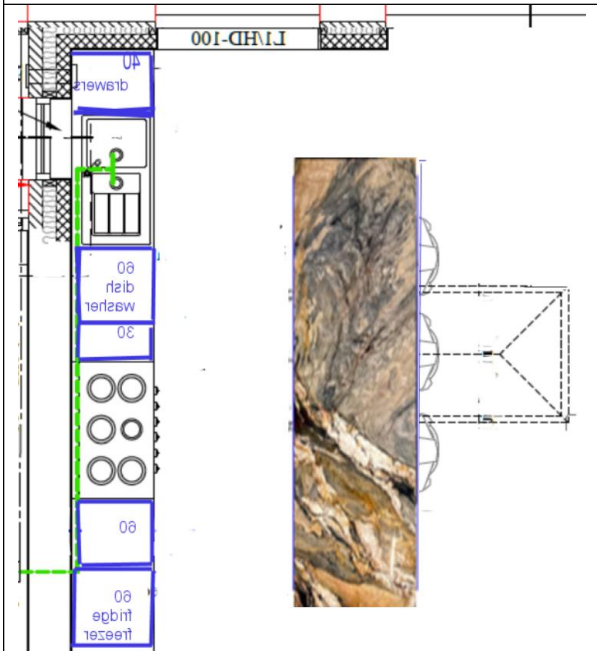
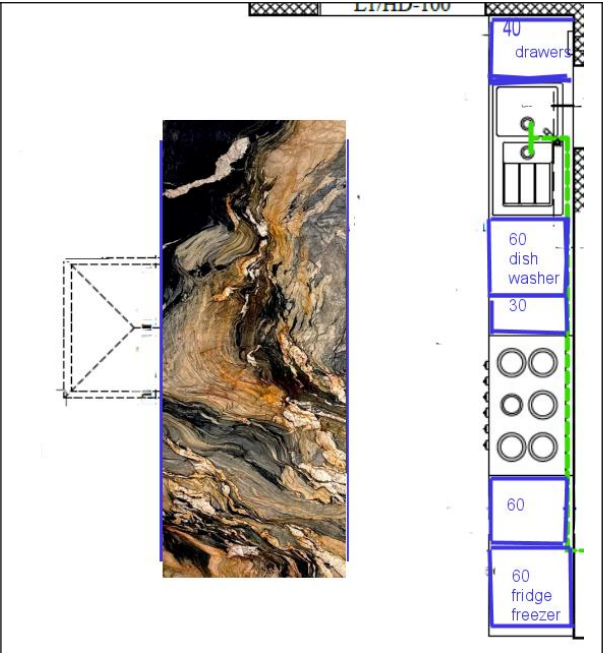
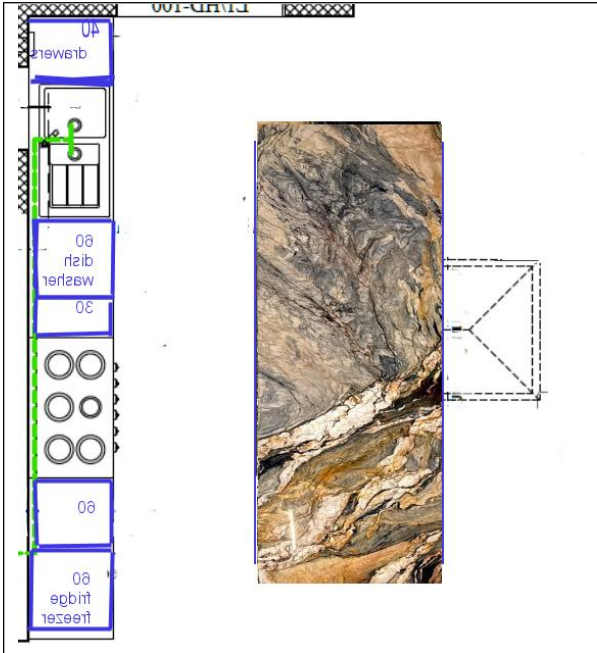

Terrazzo



Example of a flat hob hood

Composition: A mix of aggregates (marble, glass, etc.) and a binder (cement or epoxy).

Appearance: Distinctive, speckled look with varied color options.

Finish:
Can be polished for a high sheen, or honed/matte for better slip resistance, such as in bathrooms.

Methods: Available as "poured-in-place" for seamless, large areas or as precast tiles.

A popular Italian style of stone made of an aggregate of natural stone, terrazzo has the unique benefit of being possible to install "in one piece"; in other words, a large piece of stone made specially to fit a space without seams or grout lines. In addition to being sleek and luxurious, it boasts durability, sustainability, low-maintenance, scratch resistance, water resistance and more. Its longevity alone makes this aggregate stone an incredible investment for your home or business. We offer terrazzo in both resin and cement form, the former of which being perfect for bathroom and kitchen interiors.

<https://www.henderstone.co.uk/virtual-tour/index.htm>

Unit 1, Select Business Centre, Lodge Road, Staplehurst
Kent, TN12 0QW info@henderstone.co.uk

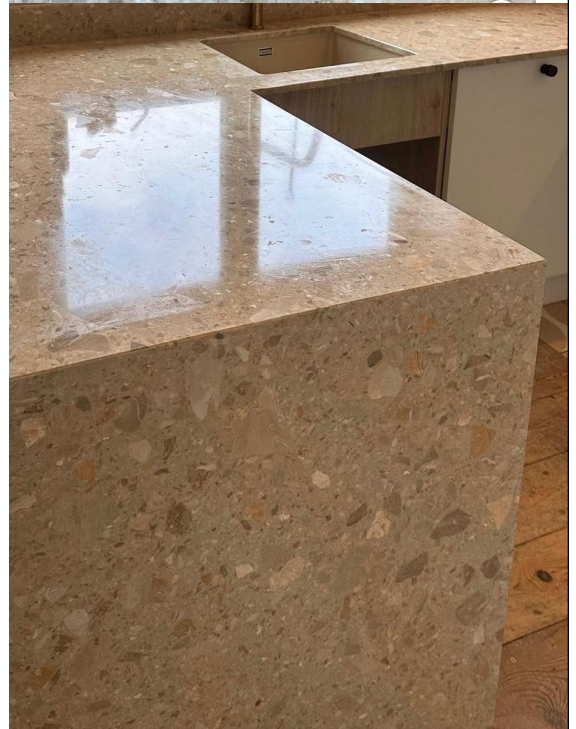
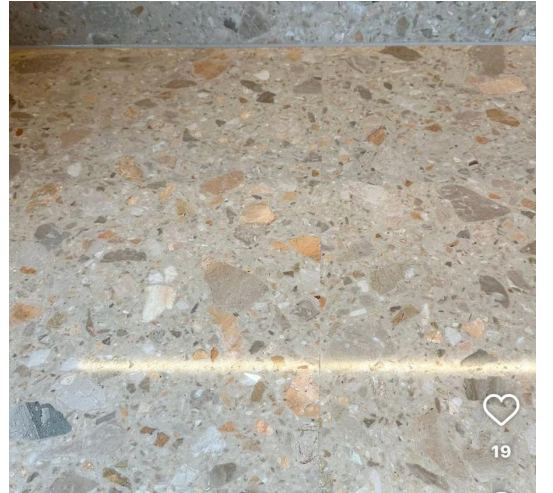
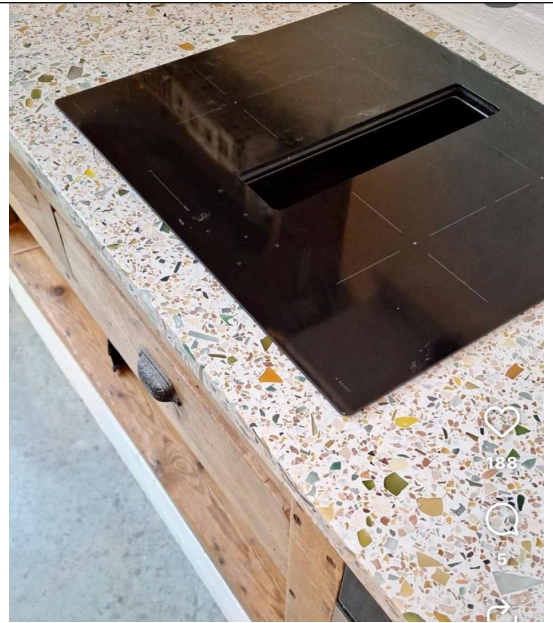
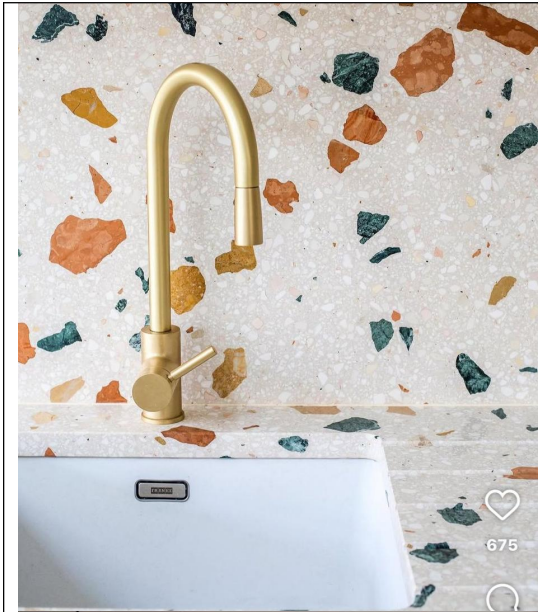



As a kitchen surface conglomerate is an excellent choice. An engineered stone, made from 90% natural materials with 10% resin, it is durable, resilient and lighter to handle than full marble or granite countertops. There's also a nod to the environment as conglomerate often uses what would otherwise be seen as waste materials.

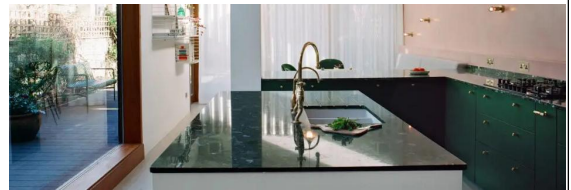

Conglomerate marble
www.diespeker.co.uk



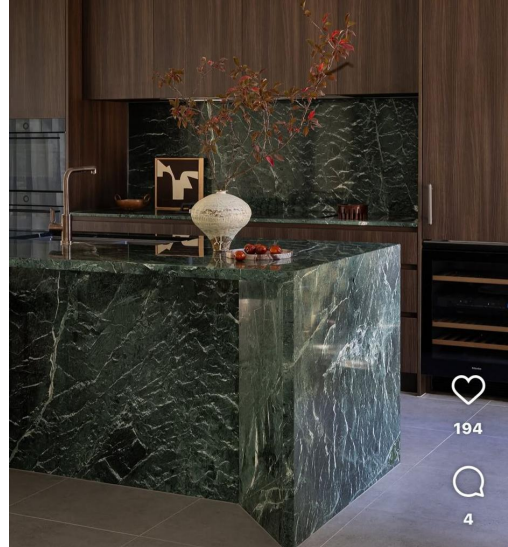
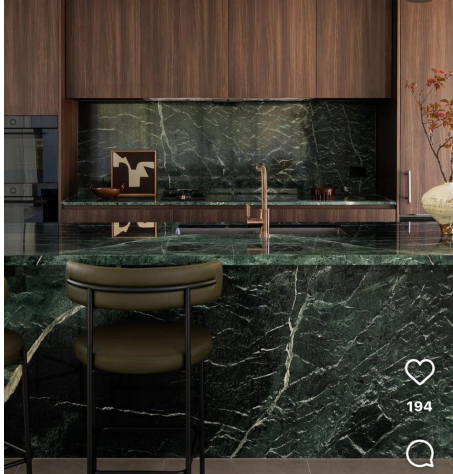
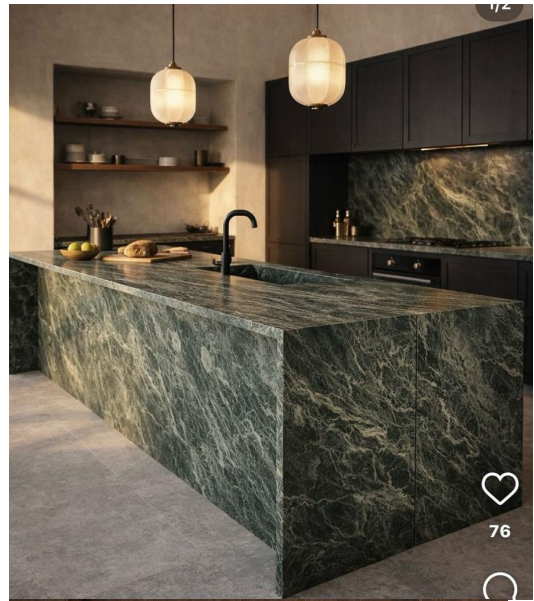
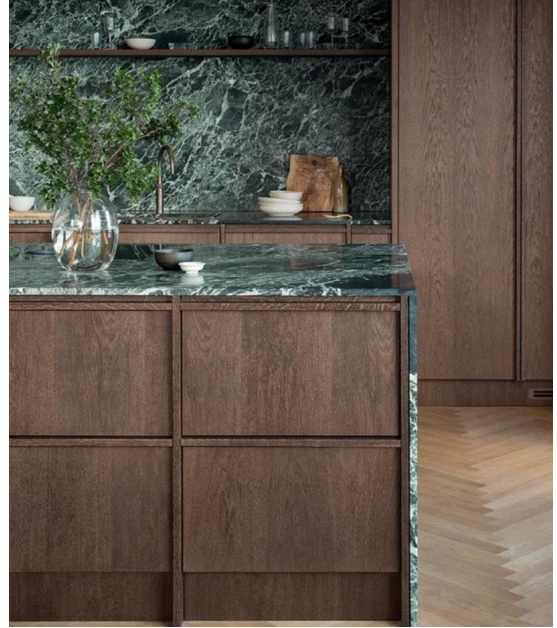
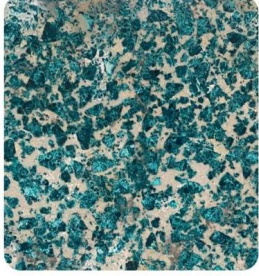



SINARP offers a timeless [design with a modern twist](#), in dark wood tones that are full of character. The solid oak edging elegantly outlines the front adding fine detail and warmth to your [kitchen](#), whilst adding stability and durability to the door. Find [more brown and wood kitchens here](#).



STENSTA dark brown ash kitchen

Elegance and warmth are the hallmarks of STENSTA dark brown stained ash veneer kitchen fronts. The vibrant grain pattern of each piece highlights the natural beauty of the material, making every front unique. Ideal for those who appreciate the natural beauty of wood and want a kitchen with character.



HAVSTORP matt beige kitchen

The HAVSTORP matt beige kitchen has smooth slab door fronts with clean lines that gives your kitchen a calm and harmonious expression. A perfect choice for those who want a [modern and neutral style](#). Find [more cream and beige kitchens here](#).



HAVSTORP matt brown-beige kitchen

The HAVSTORP kitchen in a matt brown-beige is a great choice for setting your own unique style. With clean modern lines and soft muted colour, you can create a perfect canvas for playful contrasts with lighter worktops and black appliances and accessories.



IKEA AXSTAD Grey-Green Kitchen with Light Stone Worktop & Island (No High Cabinets, No Backsplash)

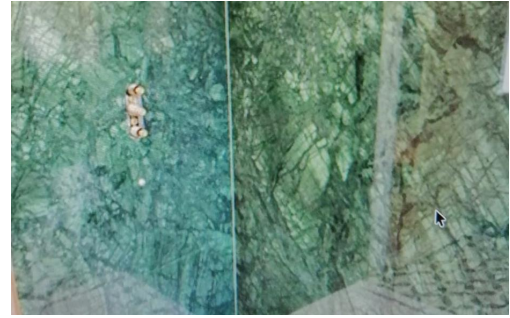

This slab Amy showed for the green was a bathroom



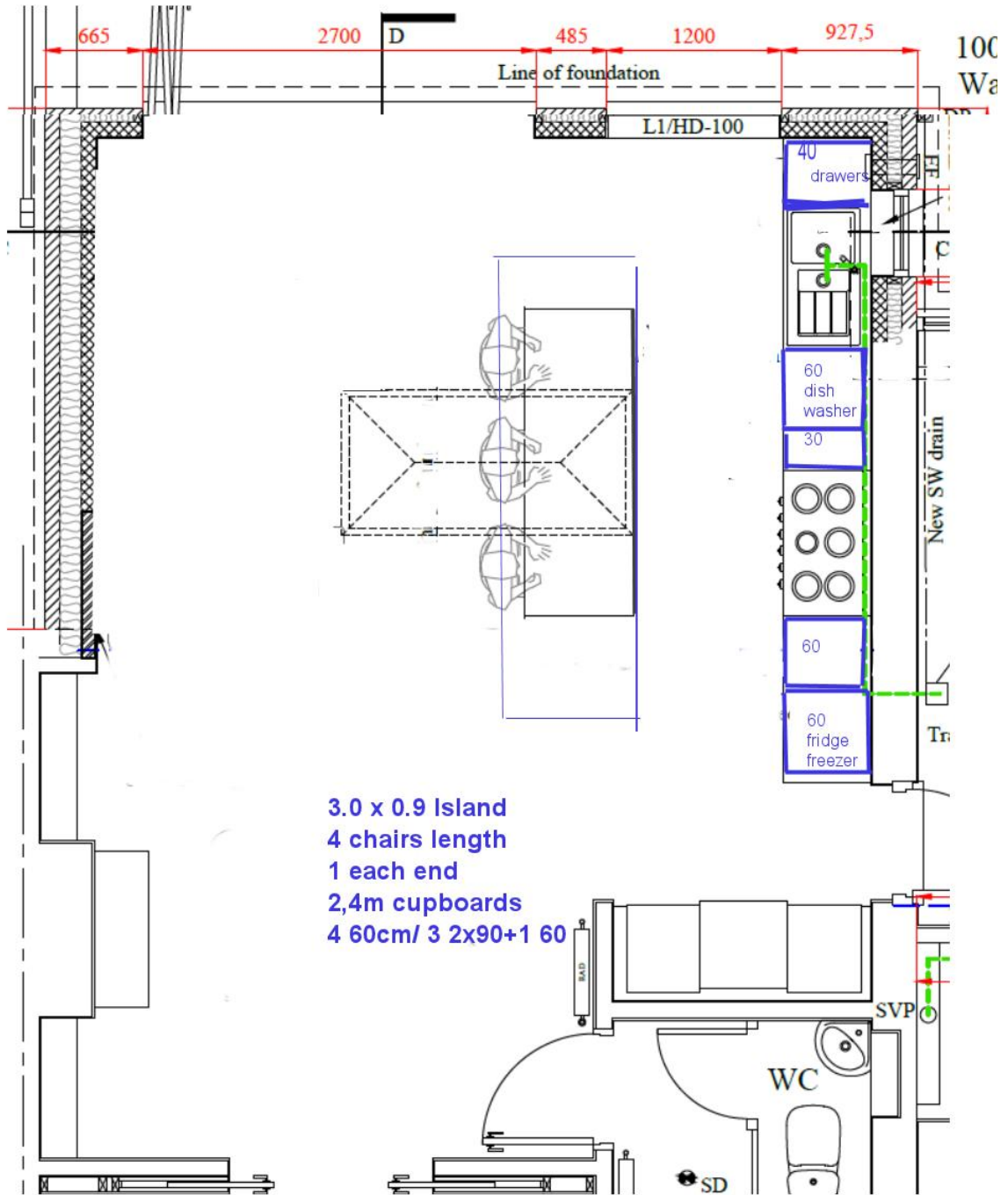

3.0 x 0.9 Island
 4 chairs length
 1 each end
 2,4m cupboards
 4 60cm/ 3 2x90+1 60

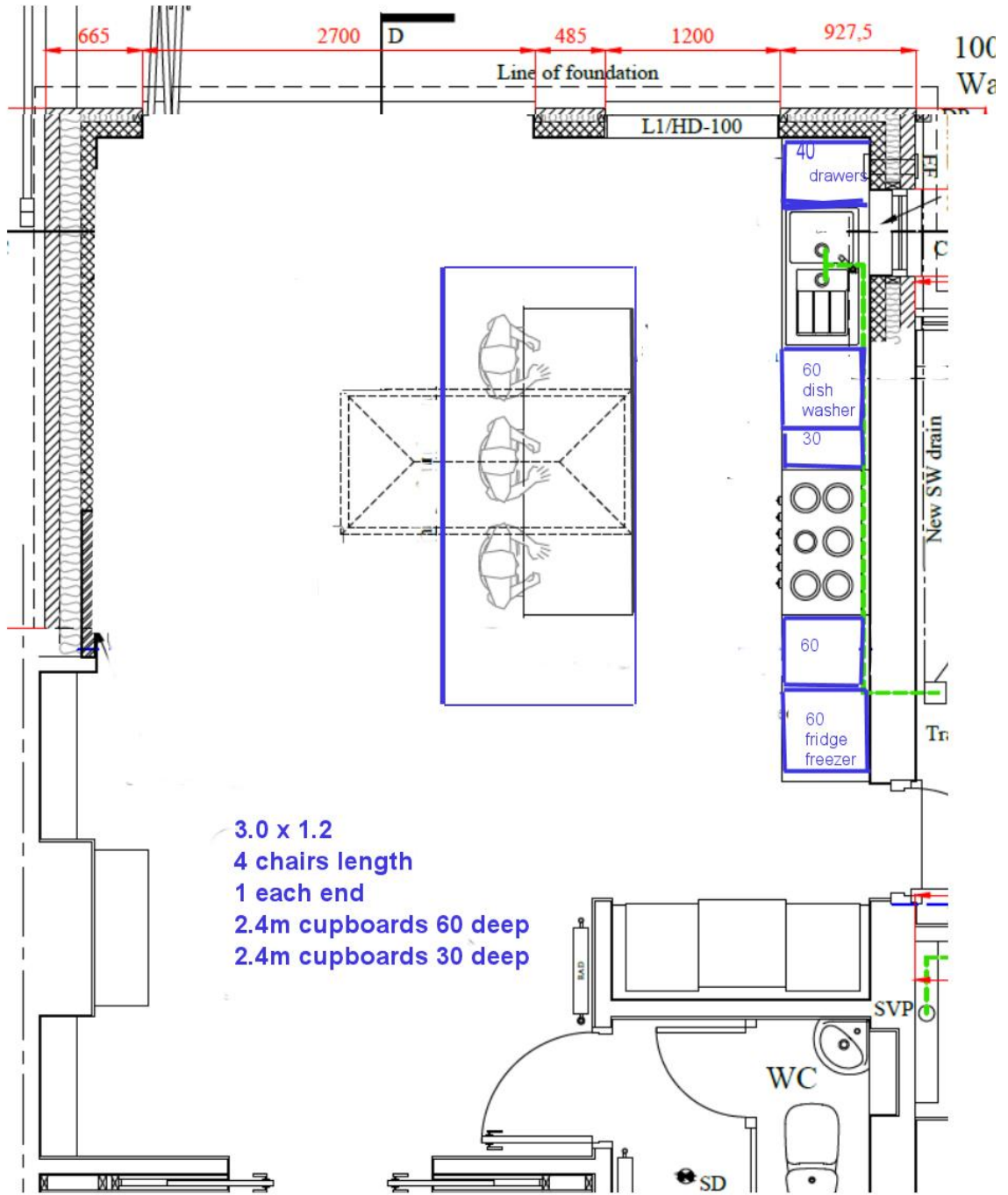

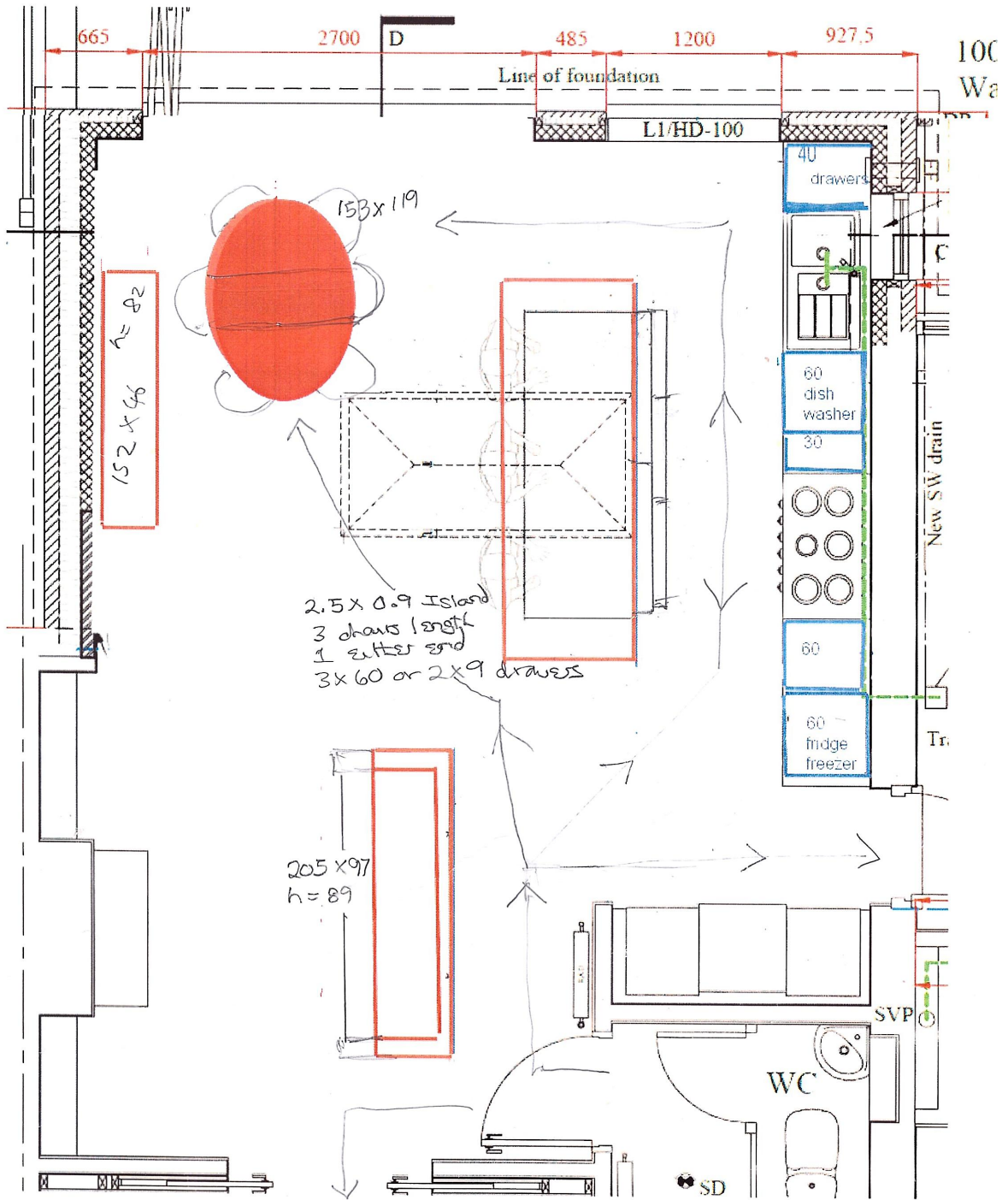

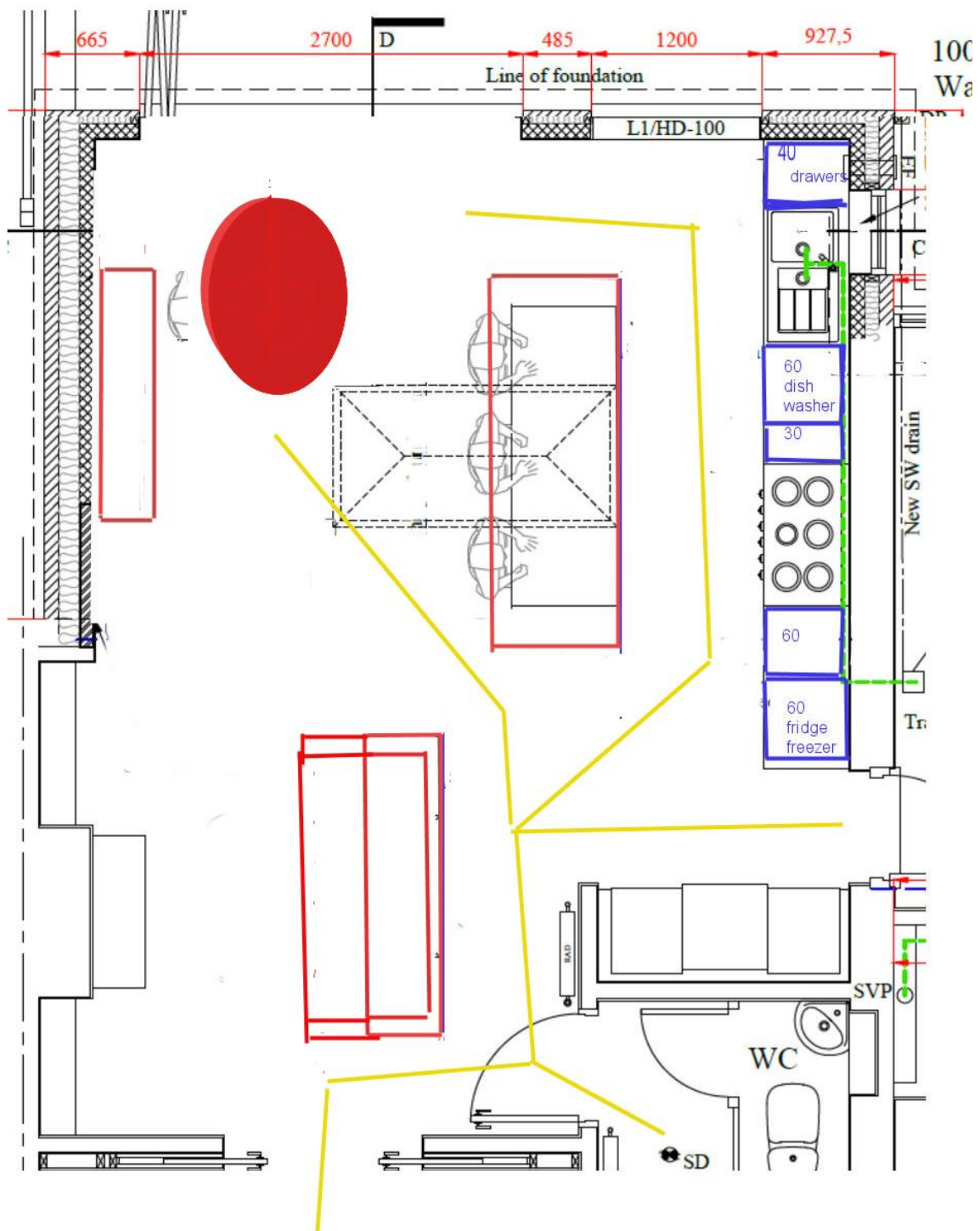



Painted the kitchen cabinet Calke Green